

CONRAD

ART

ENCOUNTERS

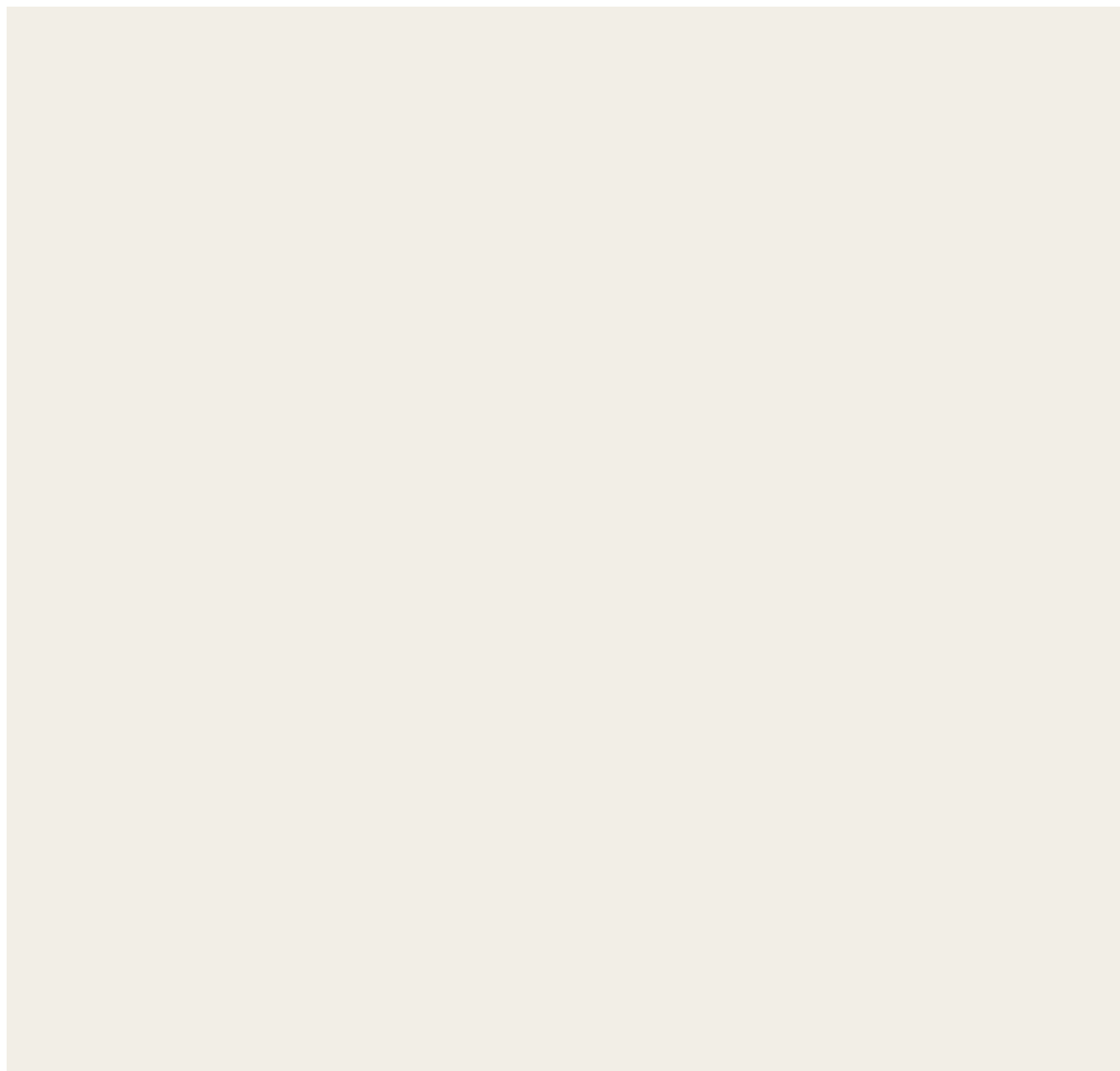

Whenever you stay at Conrad Hotels & Resorts, you will find a locally curated art collection that allows guests to embrace their interest and passion for art and design while experiencing the destination with purpose and authenticity. Conrad Art Encounters has been created to illuminate the connections between hotels' art, design and location. We invite you to immerse yourself in the Conrad Art Encounters catalog and take a self-guided tour to learn about the stories and context of individual artworks around the hotel.

Beyond the hotel, the Conrad Art Encounters catalogue will guide you through the vibrant local art scene to some of the best art venues nearby as well as how you can support local creators.

CONRAD®
LONDON ST. JAMES

PALACES, POLITICS, AND POWER

Even by the storied and characterful standards of historic central London, Conrad London St. James has a notable location. Its guests are at the heart of Westminster, where political battles play out in the Houses of Parliament, and are moments from St. James's Park, Buckingham Palace and Westminster Abbey. The hotel's 19th-century façade – Conrad London St. James sits within the former Queen Anne's Chambers, a wartime residence for civil servants – stands in elegant contrast to a stylish contemporary interior. Its collection of artworks, many by British artists, has been chosen to reflect and create a dialogue with this sense of place, as guests encounter the pieces in a London location where royal heritage and political currents mix and meet. It's then easy – and tempting – to continue your journey of historic and creative discovery beyond the hotel.



1. Chris Levine, *Equanimous 1*, 2012

Born in Canada but based in the UK, Chris Levine is a leading contemporary artist whose works are held in the collection at the National Portrait Gallery. He rose to international prominence with a series of unconventional holographic portraits of Elizabeth II, for which the monarch sat in person in 2004. *Equanimous 1* is one of these holographic images, and it encapsulates his distinctive style – intimate portrait photography in a lightbox format. Created with a 3D scanner, the late Queen's image is partially obscured in a portrait that blends traditional iconography with contemporary artistic methods and sensibilities.



2. Tom Clark, *The Ladder To*, 2022

A builder climbs the ladder of the bronze sculpture that stands tall in the lobby of Conrad London St. James. But rather than carrying bricks on his hod, he is hoisting the weight of the Houses of Parliament: the political epicentre of the UK. In this way, the Australian sculptor and painter Tom Clark depicts the essence of democratic power as residing with the common people, and as their best means of progressing onwards and – crucially – upwards.



3. Evil Robot Designs, *The House Always Wins*, 2016

Artists who call themselves Evil Ed and Dan Robotic are never going to be pompous. Working together as Evil Robot Designs, this British duo loves to play with pop culture and comic book imagery – as demonstrated by this artwork created especially for Conrad London St. James. The chamber of the House of Commons, where members of Parliament gather to debate and vote, is seen with a cast of pop-culture characters lining its famous benches: the villainous Daleks from the quintessentially British TV series *Doctor Who*, Peter Pan's enemy Captain Hook and American icons from Batman to the Simpsons are all here. Even Guy Fawkes, notorious for his failed plot to blow up the Houses of Parliament in 1605, has been given a spot. Are any of them really in control, though, given that the chamber is surrounded by ominous twirling tentacles?



4. Chris Orr, *Justice and Mayhem*, 2012

Chris Orr's prints and drawings are often inspired by British public life and societal tensions. Born and based in London, the artist has said that the protests and rioting that broke out in parts of the British capital in August 2011 are referred to indirectly in this 2012 artwork, which evokes the mob storming the Bastille at the beginning of the French Revolution. At the time of the riots, Orr was reading Charles Dickens's *A Tale of Two Cities*, which is set against the backdrop of the Revolution and explores themes of social order. On the left-hand side of the picture, the novel's protagonist, Charles Darnay, is being tried for treason.

Orr is a member of the Royal Academy whose work has been exhibited internationally. His prints and drawings are found in some of the UK's most prestigious public collections, including those of the British Museum and the National Portrait Gallery. You will find more of his works in the Blue Boar Pub at Conrad London St. James.

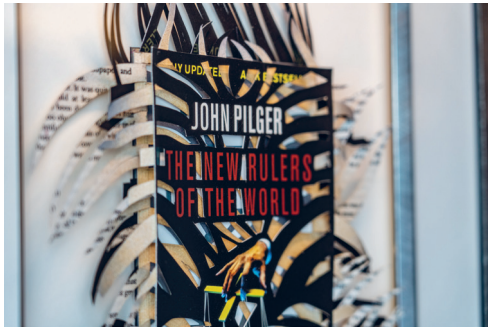

5. Georgia Russell, *Shredded Books*

The Scottish artist Georgia Russell's work features in the collections of the Victoria and Albert Museum in London and the Centre Pompidou in Paris. She slashes, cuts up, and dissects books, musical scores, maps, newspapers, and photographs, bringing "new life and meaning" to this printed matter. For her series *Shredded Books*, examples of which are displayed in the hotel's Blue Boar Pub, Russell used a scalpel to create intriguing sculptural forms.

Beyond the hotel

A CITY ALIVE WITH ART

Guests at Conrad London St. James are just moments away from world-class galleries, royal collections and exhilarating contemporary art experiences.

6. The King's Gallery

An easy 15-minute stroll from Conrad London St. James, past idyllic St. James's Park, The King's Gallery is part of Buckingham Palace, the official London residence of the British monarchy since 1837. It hosts a program of changing exhibitions showcasing different aspects of the vast and internationally renowned Royal Collection, from fine Old Masters and rare furniture to fashion and photography. Guided tours of Buckingham Palace are available if booked in advance; check online or speak to our concierge team for advice.

Buckingham Palace, London, SW1A 1AA; rct.uk/visit/the-kings-gallery-buckingham-palace

7. National Portrait Gallery

Founded in 1856 to house paintings of "the most eminent persons in British history," the National Portrait Gallery tells the story of the UK through the images of the people who have helped to shape it. Reopened in 2023 after a three-year renovation that cost £41.3 million (\$53 million), the NPG now has a rooftop restaurant and bronze doors featuring 45 female portraits by one of Britain's best-known artists, Tracey Emin. The collection spans all manner of artworks and photographs, from ordinary people to distinguished public figures, and includes a staggering 969 portraits of the late Queen.

St. Martin's Place, London WC2H 0HE; npg.org.uk

8. Fourth Plinth

On the northwest side of Trafalgar Square, in the shadow of Nelson's Column, the Fourth Plinth is one of the UK's best-loved showcases for new sculpture. Originally intended to hold an equestrian statue of William IV, it sat unused for more than 150 years until 1999, when the mayor of London invited leading contemporary artists to create large-scale works for the plinth – Rachel Whiteread, Marc Quinn, Antony Gormley, David Shrigley, Yinka Shonibare, and Katharina Fritsch are among those who have taken part in the project. Look out for the latest commission as you walk across the square – they are typically eye-catching and hard to miss.

Trafalgar Square, London WC2N 5NJ

Within the hotel

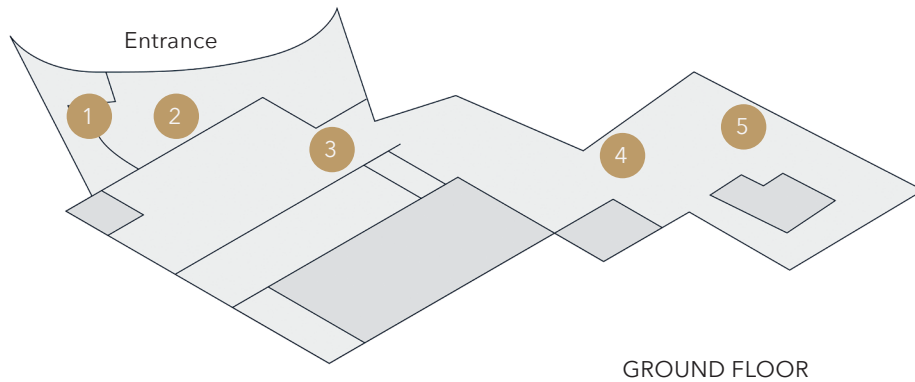

Beyond the hotel

