



Hilton
ANAHEIM

Hilton 

THE ANAHEIM
RESORT
CELEBRATING
50
YEARS

ANAHEIM
CONVENTION
CENTER

HILTON ANAHEIM
Function Space

LOCATION

Hilton Anaheim is centrally located in Southern California and is adjacent to the Anaheim Convention Center. Orange County's largest hotel defies convention hotel stereotypes by creating unique experiences for event planners and attendees and offering something unique for every size event. Surrounded by a variety of restaurants, shopping, nightlife venues and theme parks, this is the ideal location for both work and play. The hotel features extensive indoor/outdoor function space and has a diverse culinary footprint, focused on locally sourced ingredients.

MEETINGS & EVENTS

- 150,000 sq ft of function space with on-site conference services, and A/V by Encore
- Meetings & events Internet packages
- Banquets & catering services
- Twin 28,500 sq. ft. ballrooms on one level
- 73 separate meeting rooms
- Twin 19,000 sq. ft. outdoor event decks on one level
- Full audio visual services through Encore, including high speed internet capabilities
- Full service FedEx and Enterprise Rental Service
- Award winning event services team

ROOMS & AMENITIES

- 1572 guestrooms & 93 suites
- Lobby Wi-fi/In-room Wi-Fi [/\$]
- Outdoor pool & hot tubs, and kid's splash zone
- On-site dining at MIX Restaurant, MIX Lounge, Pool Bar & Grill, Starbucks®, and Food Court.
- *Disneyland®* Good Neighbor Hotel
- Heath Club & Fitness Center
- Electronic device connectivity panel
- Coffeemaker, iron and board, hairdryer, individual climate control, laptop-size safe
- Valet dry cleaning & laundry [/\$]



HERE AT HILTON ANAHEIM

Originally opened in 1984, in time for the Los Angeles Olympic Games, Hilton Anaheim's founding purpose was and still is to *bring people together* from all over the world. Rooted in one of Southern California's most iconic areas, The Anaheim Resort's history dates back more than 400 years and continues to be a work in progress. Over the years the area was transformed into a lush garden district, pedestrian-friendly, premier resort destination hosting leisure travelers, as well as group events and business travel guests. Hilton Anaheim is proud to welcome new and returning guests everyday.

CULINARY EXPERIENCE

Hilton Anaheim's culinary team is led by Executive Chef Juan Lopez, who has won numerous awards for his cuisine, Chef Juan's imaginative dishes, created from organic and natural ingredients serves a distinct and unique culinary experience. In addition to group banquets, this cuisine is offered in four venues at Hilton Anaheim.



ANAHEIM RESORT

Neighboring the Anaheim Convention Center and Disneyland® Resort, Hilton Anaheim lives in the heart of the Anaheim Resort. Enjoy a shopping spree at the South Coast Plaza, Dine at The Anaheim Garden Walk, catch a show at The House of Blues, watch the Angels hit a homerun, or spend the day at nearby famous Orange County beaches just moments away.

HOTEL SERVICES

- Valet parking – E/V charging available
- On-site parking garage for self-parking
- Pool, two hot-tubs, sun deck, and family friendly splash zone
- Full service on-site FedEx Store
- Exclusive *Disneyland®* Resort ticket website
- Enterprise Rent-A-Car
- Disney themed Character Club Souvenir Shop
- Hotel Gift Shop and Sundry
- On-site clean beauty salon – Pure Escape
- Laundry facility and dry-cleaning services [*\$*]
- Check In: 4:00pm/Check Out: 12:00pm

DINING

- Mix Restaurant: Seasonal cuisine for all palates and preferences, serving breakfast, lunch and dinner.
- Mix Lounge: Indulge in signature cocktails, tapas-style plates, and an open lobby lounge experience with high ceilings and ambiance.
- Chef's Table: An exciting culinary experience for Hilton guests, integrated into the hotel's kitchen, featuring a customized three-dimensional "Wall of Wine."
- Pool Bar & Grill: Alfresco, pool-side dining. Offered seasonally, featuring wood-fired grills, sandwiches and snacks.



CATALINA MEETING ROOMS

LOWER LOBBY

Located on the lower lobby is a unique Executive Conference Center that features Seven (7) **Catalina Meeting Rooms** and the Catalina Lounge. The Lower Lobby is also home to the Health Club and Presentation Services, Audio Visual.

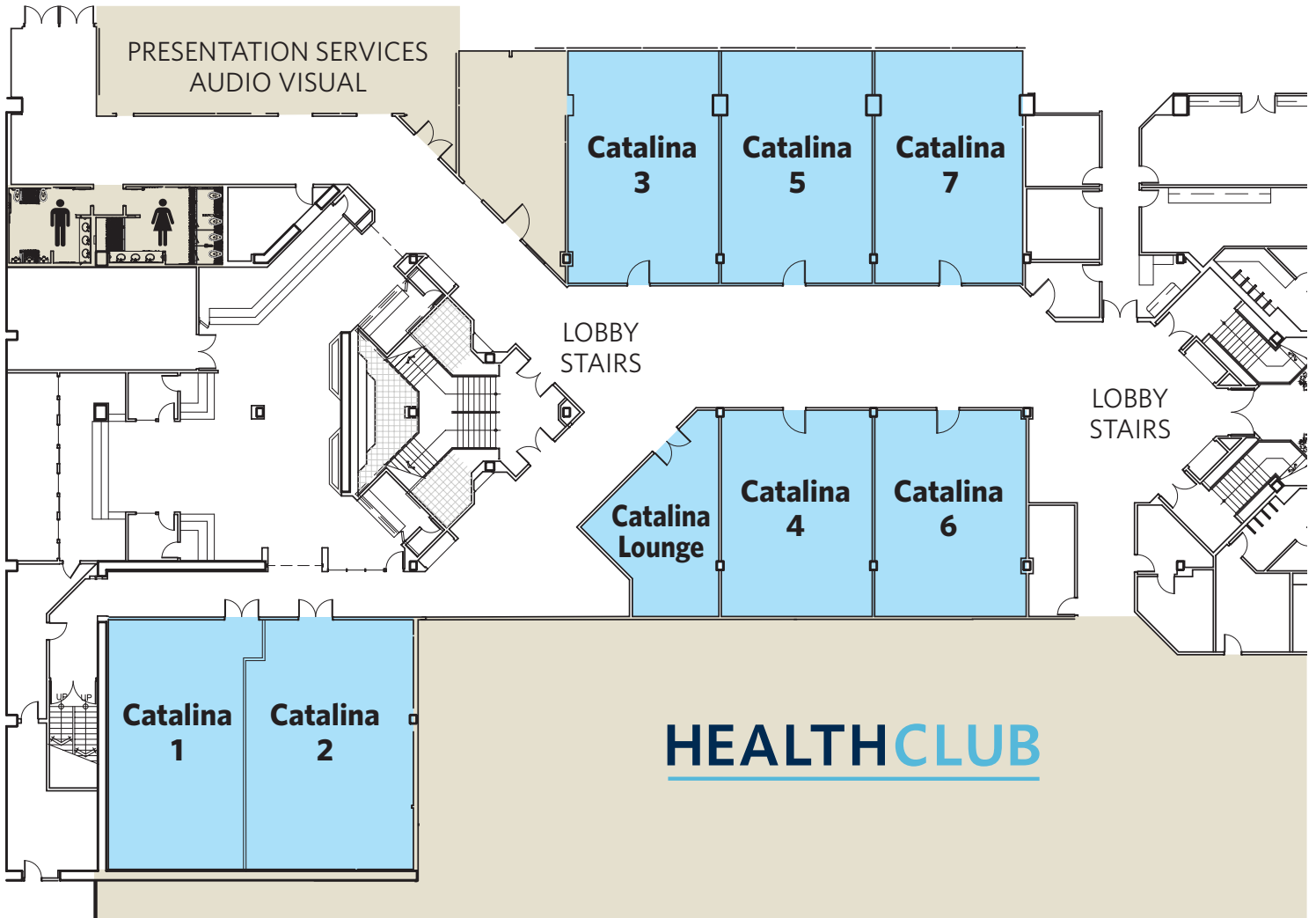

Room	Dimensions L x W	Square Feet	Theatre	Classroom (2/6')	Classroom (3/6')	72" Rounds of 12	72" Rounds of 10	Reception	Conference	U-Shape	Hollow Square
Catalina 1	24x38	970	80	28	40	60	50	100	22	28	26
Catalina 2	22x43	990	80	28	40	48	40	100	22	28	26
Catalina 3	37x27	1000	70	28	40	60	50	100	22	28	26
Catalina 4	37x27	1000	70	28	40	60	50	100	22	28	26
Catalina 5	38x27	1026	80	30	45	60	50	100	22	28	26
Catalina 6	38x27	1026	80	30	45	60	50	100	22	28	26
Catalina 7	38x27	1026	80	30	45	60	50	100	22	28	26

The Catalina Lounge is approximately 400 sq. ft. and ideally used to host Food and Beverage for breaks throughout the day

***Ceiling Height for all Catalina Meeting Rooms - 9'0"**

LOBBY LEVEL

FIRST FLOOR

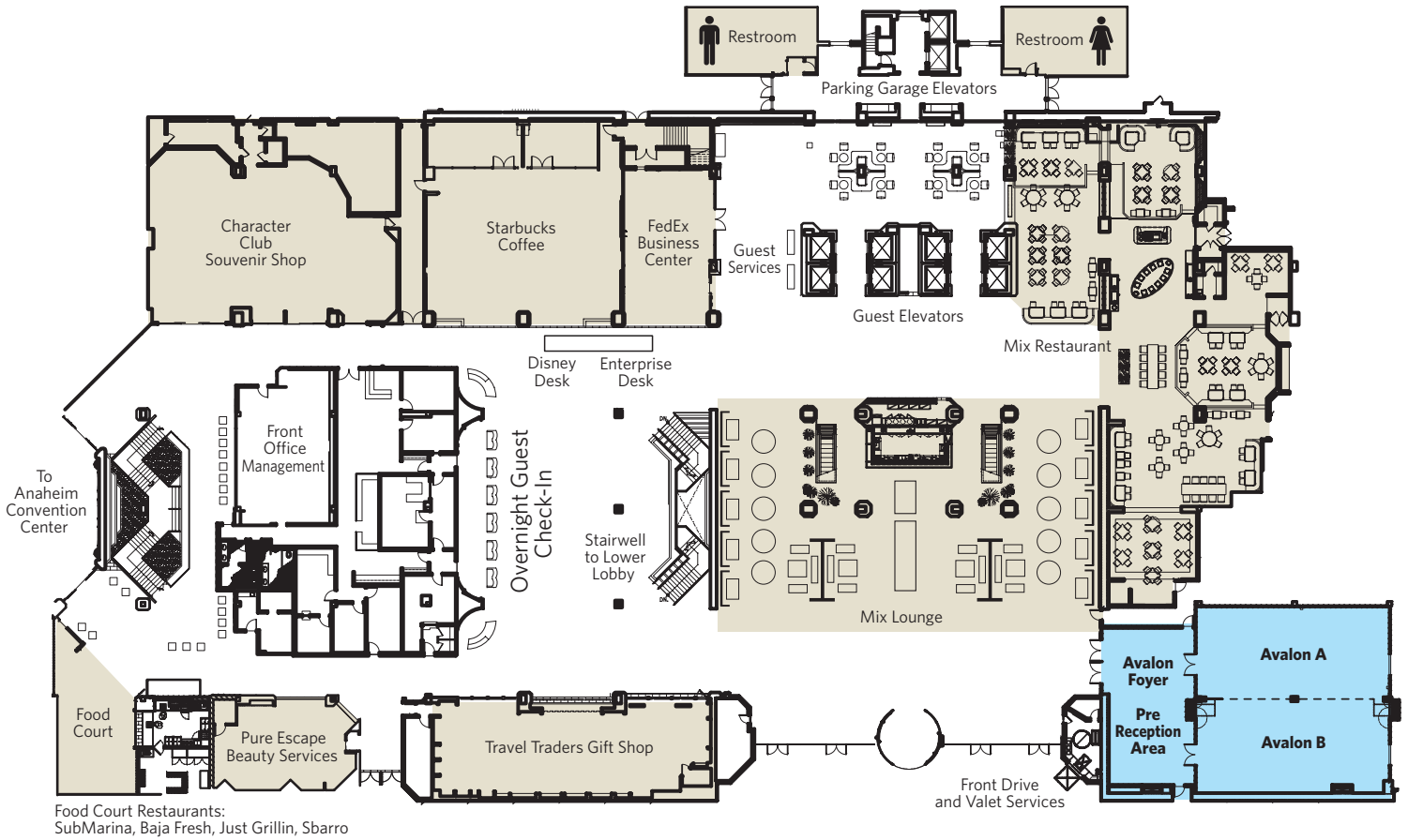

Room	Dimensions L x W	Square Feet	Ceiling Height	Theatre	3 per 6' Classroom	72" Rounds of 12	72" Rounds of 10	Reception	U-Shape	Conference	Hollow Square
Avalon A	54 x 26	1,248	11'8"	130	80	96	80	90	36	36	40
Avalon B	54 x 26	1,248	11'8"	130	80	96	80	90	36	36	40
Avalon Combined	54 x 52	2,496	11'8"	240	150	192	160	200	NA	NA	NA

*Capacities are based upon maximum sets. Numbers may vary based upon the addition of AV, staging, decor, food stations, etc.

The elegant **Avalon Ballroom**, conveniently located on the lobby level features a unique and private pre-reception area at just over 950 square feet and is the perfect venue for an intimate reception or dinner.



Avalon Foyer

BALLROOM LEVEL

SECOND FLOOR

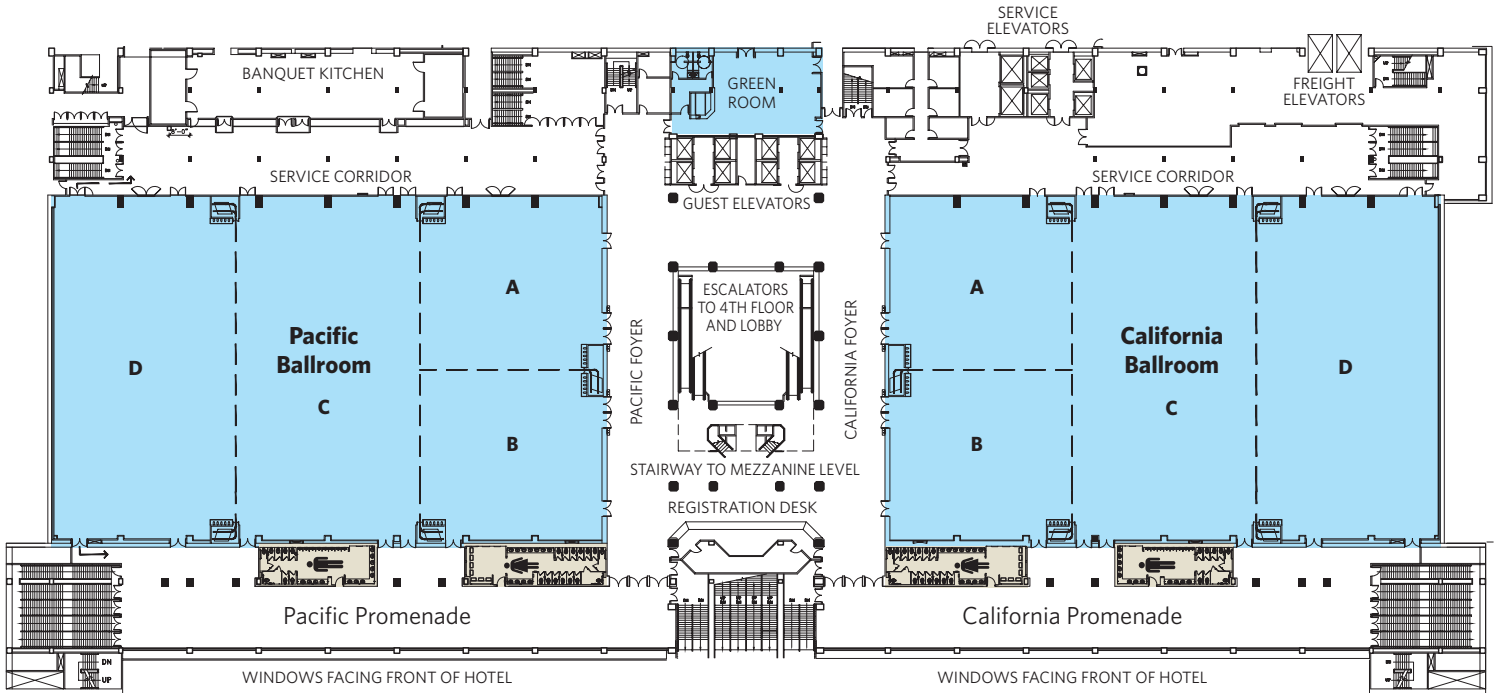

The **Pacific Ballroom** and the **California Ballroom**, located on the second floor, each accommodate 2,500 for receptions, 2,000 for banquets and theater style seating for 2,800. They are ideal for large exhibits, holding 176 booths each. An elegant 11,215 sq. ft. pre-function foyer and convention registration desk joins the two ballrooms for additional flexibility and optimum traffic flow.

Room	Dimensions L x W	Square Feet	Ceiling Height	Theatre	School Room (2/6')	School Room (3/6')	72" Rounds of 12	72" Rounds of 10	Reception	U-Shape	Conference	Hollow Square
Pacific Ballroom	213 x 134	28,542	20'	2,800	950	1,400	2,040	1700	2,500	NA	NA	NA
A	70 x 69	4,830	20'	400	150	240	300	250	400	58	52	68
B	70 x 65	4,550	20'	400	150	240	300	250	400	58	52	68
C	73 x 134	9,782	20'	900	350	450	720	600	800	105	NA	NA
D	70 x 134	9,380	20'	900	350	450	720	600	800	105	NA	126
California Ballroom	213 x 134	28,542	20'	2,800	950	1,400	2,040	1700	2,500	NA	NA	NA
A	70 x 69	4,830	20'	400	150	240	300	250	400	58	52	68
B	70 x 65	4,550	20'	400	150	240	300	250	400	58	52	68
C	73 x 134	9,782	20'	900	350	450	720	600	800	105	NA	NA
D	70 x 134	9,380	20'	900	350	450	720	600	800	105	NA	126
Foyer	181 x 109	11,215	8'6"	NA	NA	NA	NA	NA	500	NA	NA	NA
Promenade	209 x 22'6"	4,600	13'	NA	NA	NA	NA	NA	600	NA	NA	NA
Green Room	49 x 30	1,450	8'	NA	NA	NA	48	40	75	NA	18	NA

*Capacities are based upon maximum sets. Numbers may vary based upon the addition of AV, staging, decor, food stations, etc. Ballrooms feature - 20'x 15' Electric drop down screens centered on West wall and the North walls of A, C and D.

Exhibit Space	Booths 8 x 10	Booths 10 x 10	Floor Surface	Floor Load Lbs./Sq. Ft.	Lighting
Pacific/California Ballroom	176	140	Carpet	100 lbs.	Recessed
Pacific/California Ballroom A	28	22	Carpet	100 lbs.	Recessed
Pacific/California B	27	23	Carpet	100 lbs..	Recessed
Pacific/California C	65	40	Carpet	100 lbs.	Recessed
Pacific/California D	56	38	Carpet	100 lbs.	Recessed
Promenades	17	NA	Carpet	100 lbs.	Recessed

Note: Water/Drain: Located on the East wall in California Pavilion D and the West wall in Pacific Ballroom D.



Pacific Promenade

MEZZANINE LEVEL

THIRD FLOOR

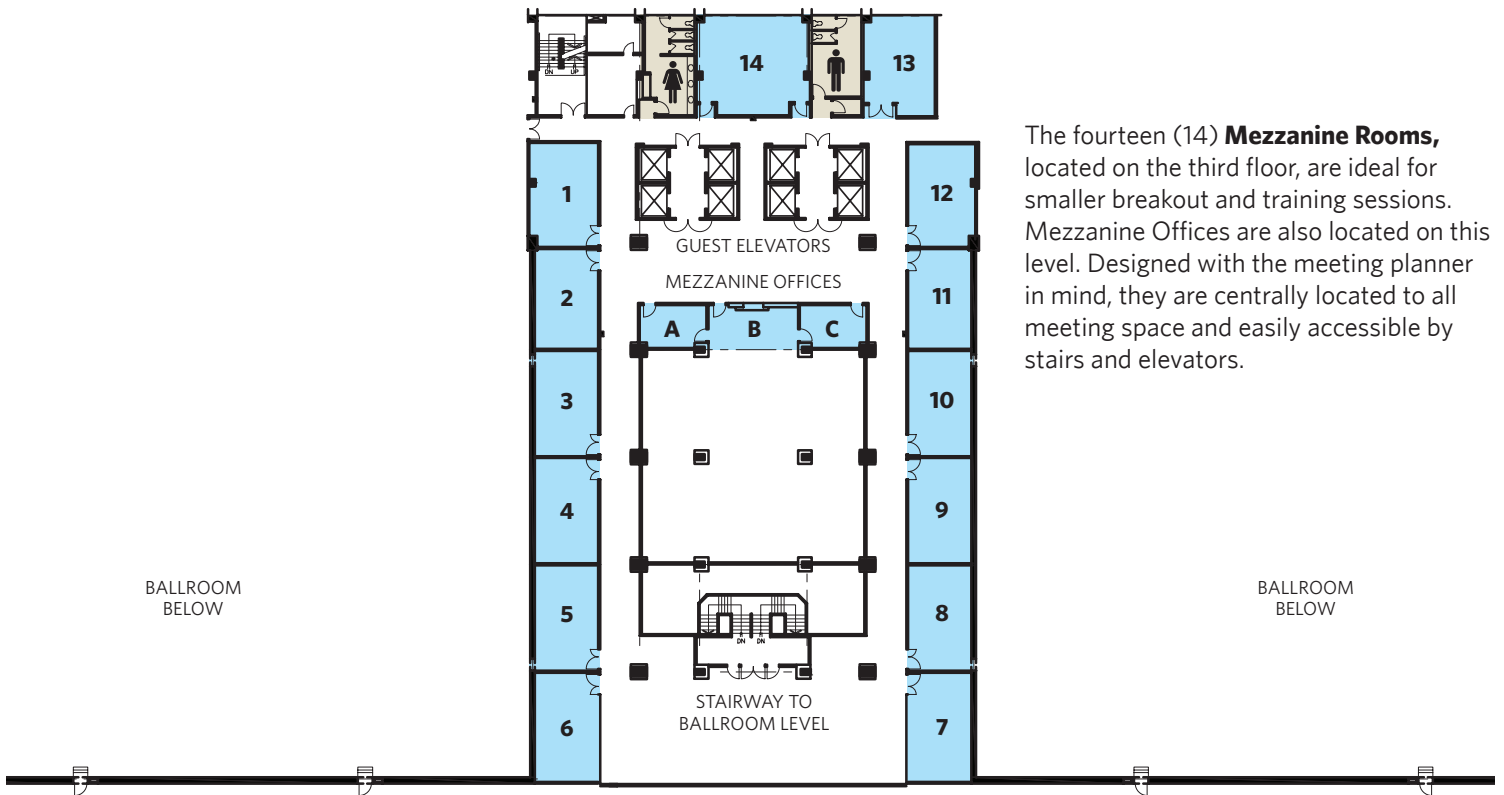

The fourteen (14) **Mezzanine Rooms**, located on the third floor, are ideal for smaller breakout and training sessions. Mezzanine Offices are also located on this level. Designed with the meeting planner in mind, they are centrally located to all meeting space and easily accessible by stairs and elevators.

Room	Dimensions L x W	Square Feet*	Ceiling Height	Theatre	School Room (2/6')	School Room (3/6')	72" Rounds of 10	Reception	U-Shape	Conference	Hollow Square
Mezzanine Room 1	24 x 17	408	7'4"	30	16	22	30	25	20	18	18
Mezzanine Room 2	26 x 15	390	7'4"	30	16	22	30	25	20	18	18
Mezzanine Room 3	26 x 15	390	7'4"	30	16	22	30	25	20	18	18
Mezzanine Room 4	26 x 15	390	7'4"	30	16	22	30	25	20	18	18
Mezzanine Room 5	26 x 15	390	7'4"	30	16	22	30	25	20	18	18
Mezzanine Room 6	27 x 15	405	7'4"	30	16	22	30	25	20	18	18
Mezzanine Room 7	27 x 15	405	7'4"	30	16	22	30	25	20	18	18
Mezzanine Room 8	26 x 15	390	7'4"	30	16	22	30	25	20	18	18
Mezzanine Room 9	26 x 15	390	7'4"	30	16	22	30	25	20	18	18
Mezzanine Room 10	26 x 15	390	7'4"	30	16	22	30	25	20	18	18
Mezzanine Room 11	26 x 15	390	7'4"	30	16	22	30	25	20	18	18
Mezzanine Room 12	24 x 17	408	7'4"	30	16	22	30	25	20	18	18
Mezzanine Room 13	25 x 18	450	7'4"	30	16	22	30	24	20	18	18
Mezzanine Room 14	29 x 21	609	7'4"	45	20	30	40	40	24	22	26
Mezzanine Offices											
A	17 x 12	204	7'4"		Meeting Planners' Office		10		NA	NA	NA
B	21 x 12	252	7'4"		Meeting Planners' Office		10		NA	NA	NA
C	17 x 12	204	7'4"		Meeting Planners' Office		10		NA	NA	NA

CONCOURSE LEVEL

FOURTH FLOOR



The **Concourse Level Rooms**, located on the fourth floor, offer unparalleled flexibility which can be utilized in a number of ways. This entire floor is dedicated to a series of 37 meeting rooms, which are designed for small to medium sized meetings, seminars, receptions, or banquets. The Executive Board Room and Ante Room sit directly in the middle of the floor and are ideal location for executive-level meetings.

GENERAL INFORMATION

CHANDELIERS CLEARANCE/HANG POINT

- Pacific Ballroom – 19'
- California Ballroom – 19'
- Pacific/California Promenades – 12'6"
- Each ballroom has 72 rig points

LOADING DOCKS

Single four-bay dock located on the East side of the Hotel. Served by two large freight elevators and two service elevators outlined below. Loading area is adjustable from ground level up to 4'. Each bay will accommodate a 53' truck.

FREIGHT ELEVATORS

Serving Loading Dock, Ballroom Level

Two freight elevators with interior dimensions of:

20' L x 9'8" W x 9' 11" H

Capacity: 10,000 lbs.

Access to ballrooms via service corridors.

SERVICE ELEVATORS

Serving Loading Dock, Lower Lobby, 2nd-4th Floors

Two service elevators with interior dimensions of:

7'8" L x 9'8" W x 8' H

Capacity: 6,000 lbs.

Access to ballrooms and meeting rooms via service corridors.

Note: An additional five internal service elevators are available for smaller deliveries to all floors.

PERMANENT SCREENS

- Pacific Ballroom – 20'x 15' Electric drop down screens are centered on

the North walls of A, C and D.

- California Ballroom – 20'x 15' Electric drop down screens are centered on the North walls of A, C and D.

STAGE SIZES

Portable staging is available in 6' X 8' sections with adjustable heights of 16", 24" or 32".

DANCE FLOORS

Portable dance floors can be set in any appropriate location within the building. Each section measures 3' x 3'.

AUDIO VISUAL

Presentation Services Audio Visual is the Hilton Anaheim's in house provider for all Audio Visual, Rigging, Power and Internet needs. Located on the Lower Lobby level, PSAV is on site to handle your program from start to finish.

ELECTRICAL/ IT SOLUTIONS/COMMUNICATIONS/ RIGGING

- There is 25-60 amp/3phase, 5 wire 208v connections (Pin and sleeve Hubbell #HBL560) located in the walls throughout the ballrooms. Meeting rooms located on the third and fourth floor contain convenience outlets on each wall. Additional power is available upon request.
- Our meeting space is equipped with multiple data ports in each room that can provide PoE that is connected through a fiber backbone that can deliver 500MB burstable to 1GB of bandwidth. We have a dedicated on-site team to support all of your IT and Communication needs.
- Presentation Services is the exclusive rigging contractor for the Hilton Anaheim. Presentation Services is responsible to ensure overhead safety for all public Function Space within the hotel. Rigging encompasses attaching motors, trussing, lighting and audio to the ceiling.

Room	Dimensions L x W	Square Feet	Ceiling Height	Theatre	School Room (2/6')	School Room (3/6')	72" Rounds of 12	72" Rounds of 10	Reception	U-Shape	Conference	Hollow Square
Sunset	24 x 21	504	7'6"	52	22	32	36	30	35	16	14	20
Salinas	28 x 18	504	7'6"	64	22	32	36	30	40	20	18	20
Monterey	29 x 26	754	7'6"	74	28	40	48	40	60	22	20	26
Carmel	38 x 26	988	7'6"	80	30	45	60	50	75	26	22	26
San Simeon	38 x 52	1,976	7'6"	150	70	100	120	100	150	36	36	38
A	38 x 28	1,064	7'6"	90	28	40	60	50	75	24	22	26
B	38 x 24	912	7'6"	80	28	40	60	50	75	24	22	26
Avila	38 x 53	2,014	7'6"	150	70	100	120	100	150	36	36	38
A	38 x 29	1,102	7'6"	80	30	42	60	50	75	24	22	26
B	38 x 24	912	7'6"	80	30	42	60	50	75	24	22	26
Palisades	55 x 32	1,760	7'6"	80	30	42	72	60	80	20	18	26
El Capitan	42 x 51	2,142	7'6"	150	70	100	120	100	150	36	36	38
A	42 x 23	966	7'6"	84	32	46	60	50	75	24	22	26
B	42 x 28	1,176	7'6"	84	32	46	72	60	75	26	24	28
Santa Barbara	25 x 16	400	7'6"	30	16	22	24	20	25	20	18	18
Ventura	26 x 16	416	7'6"	30	16	22	24	20	25	20	18	18
Malibu	45 x 26	1,170	7'6"	130	52	78	72	60	90	26	30	28
Santa Monica	44 x 23	1,012	7'6"	125	52	78	72	60	90	26	30	28
Manhattan	32 x 27	864	7'6"	80	28	40	60	50	75	24	22	26
Redondo	32 x 26	832	7'6"	80	28	40	60	50	75	24	22	26
Palos Verdes	32 x 53	1,696	7'6"	150	70	100	120	100	150	34	36	38
A	32 x 29	928	7'6"	80	28	40	60	50	75	24	22	26
B	32 x 24	768	7'6"	80	28	40	60	50	75	24	22	26
Huntington	32 x 79	2,528	7'6"	280	86	130	192	160	200	44	52	48
A	32 x 25	800	7'6"	80	30	42	48	40	40	24	22	26
B	32 x 31	992	7'6"	84	34	48	72	70	75	26	24	30
C	32 x 23	736	7'6"	80	30	42	48	40	40	24	22	26
Lido A	26 x 15	390	7'6"	30	16	22	24	20	25	20	18	18
Lido B	26 x 15	390	7'6"	30	16	22	24	20	25	20	18	18
Lido C	28 x 15	420	7'6"	30	16	22	24	20	25	20	18	18
Balboa A	26 x 15	390	7'6"	30	16	22	24	20	25	20	18	18
Balboa B	26 x 15	390	7'6"	30	16	22	24	20	25	20	18	18
Balboa C	28 x 15	420	7'6"	30	16	22	24	20	25	20	18	18
Laguna	32 x 80	2,560	7'6"	280	86	130	192	160	200	44	52	48
A	32 x 56	1,792	7'6"	170	70	100	144	120	150	38	46	40
B	32 x 24	768	7'6"	60	20	30	36	30	40	24	24	26
Capistrano	32 x 52	1,664	7'6"	150	70	100	120	100	150	34	40	38
A	32 x 28	896	7'6"	80	28	40	60	50	75	24	22	26
B	32 x 24	768	7'6"	80	28	40	60	50	75	24	22	26
San Clemente	33 x 26	858	7'6"	80	30	42	60	50	75	24	22	26
Oceanside	33 x 27	891	7'6"	80	30	42	60	50	75	24	22	26
La Jolla	25 x 24	600	7'6"	50	20	28	36	30	30	20	18	22
Coronado	25 x 25	625	7'6"	50	20	28	36	30	30	20	18	22
Executive Board Room***	56 x 26	1,456	7'6"	NA	NA	NA	NA	NA	20	NA	20	NA
& Ante Room	28 x 19	532	7'6"	NA	NA	NA	NA	NA	20	NA	NA	NA

** Capacities are based upon maximum sets. Numbers may vary based upon the addition of AV, decor, food stations, etc.

*** Existing boardroom table with 20 leather chairs

POOL DECK

FIFTH FLOOR

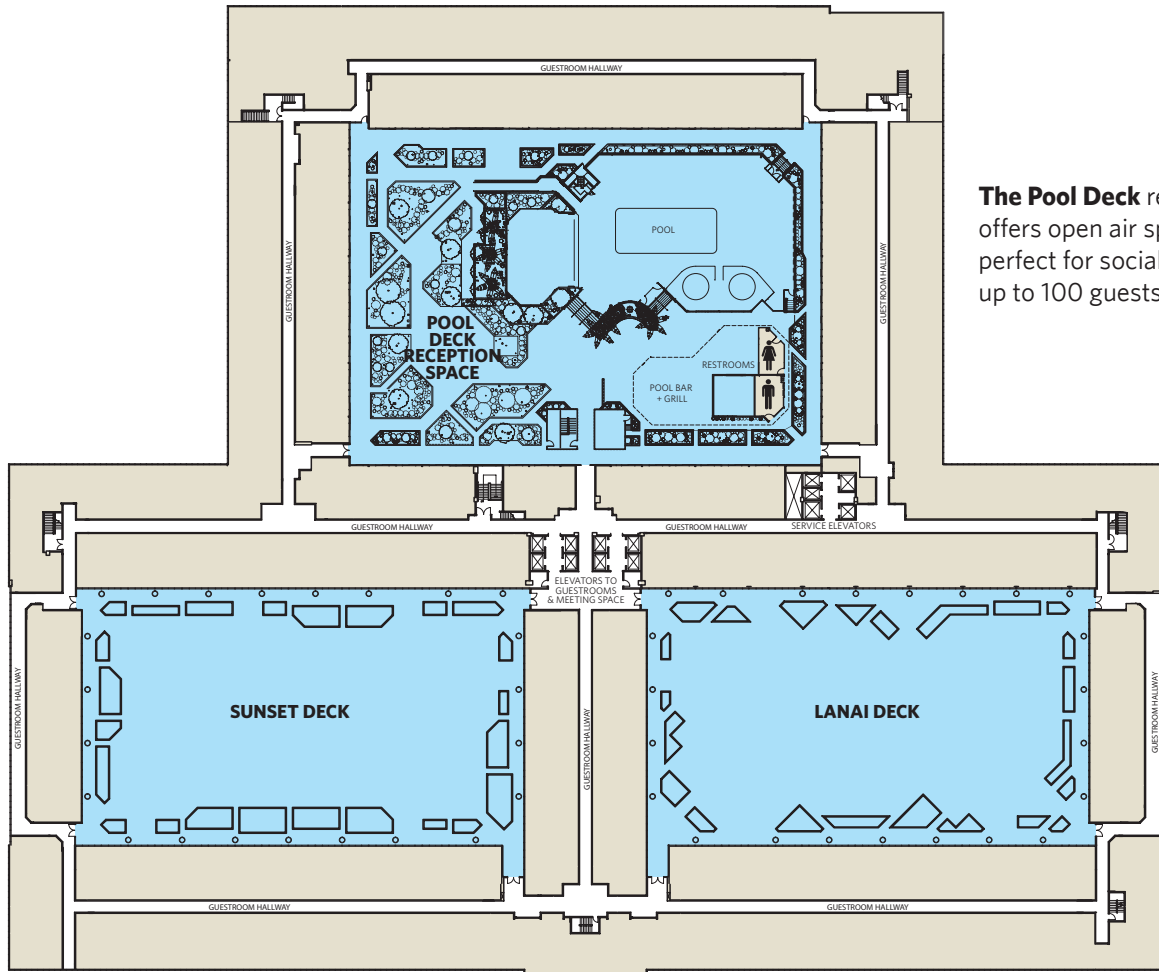

The Pool Deck reception area offers open air space that is perfect for social gatherings for up to 100 guests.

The Lanai and Sunset Deck on the fifth floor are two beautifully landscaped open air spaces. Each deck offers 19,000 sq. ft. of flexible space. This space is ideal for social gatherings, banquets, ceremony or themed private events. Tenting and open air canopies are permissible. Each deck has two, 60 amp/3 phase, 5 wire 208 v.

Room	Square Feet	Ceiling Height	72" Rounds of 12	Reception
Sunset/Lanai Deck	19,000	N/A	924	900
Pool Deck Reception Space	900	N/A	60	100

VISTA LOUNGE

FOURTEENTH FLOOR

DISNEY FACING VIEW

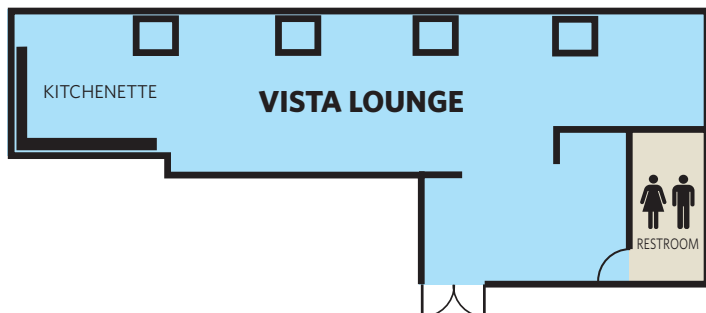

The Vista Lounge is the perfect spot to host a small function or special occasions such as a birthday party, bridal shower, baby shower, graduation or anniversary. Capacity is 75-100.

Room	Square Feet	Ceiling Height	60" Banquet	Reception	Conference
Vista Lounge	1,106	9'	40	75	20



VISTA LOUNGE
FOURTEENTH FLOOR



POOL DECK
FIFTH FLOOR

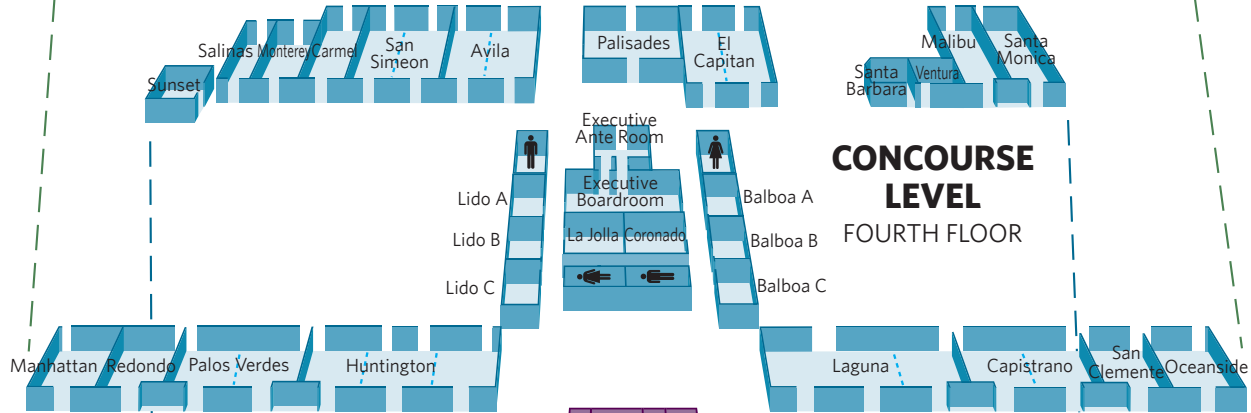

CONCOURSE LEVEL
FOURTH FLOOR

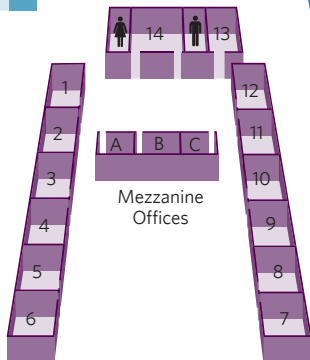

MEZZANINE LEVEL
THIRD FLOOR

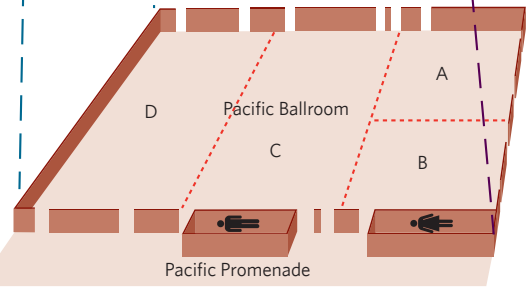

BALLROOM LEVEL
SECOND FLOOR

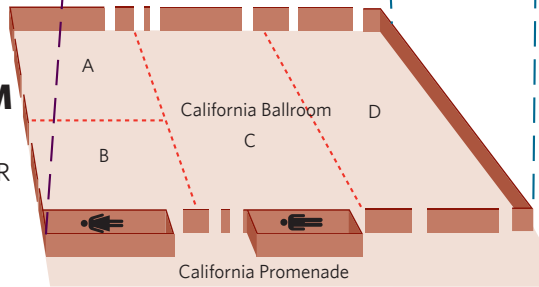

LOWER LOBBY LEVEL

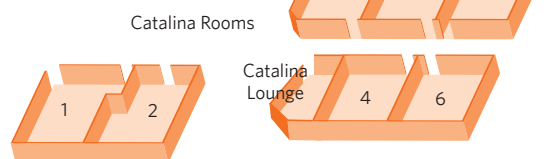

PreReception Room

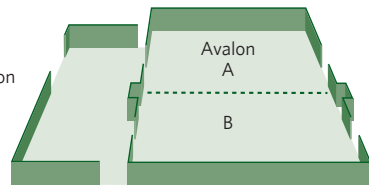

LOBBY LEVEL
FIRST FLOOR

Hilton Anaheim's meeting space is stacked directly above and below the main lobby for easy attendee navigation and so planners can create separation between their sessions.